

PRESIDENT'S MESSAGE

Sal Guarino

I would like to begin my message by apologizing to all members for skipping our year-end General Membership Meeting, wherein we address the issue of our year-end financials, together with discussing our budget and goals for the year 2007. Of most importance at this meeting is the selection of nominees to serve on the Board of Directors for the 2007 and 2008. The Board is now ready to address all these issues and has scheduled the next General Membership Meeting for Tuesday, March 20, 2007. The meeting will be held at the Northshore Convention Center from 7P.M. to 9P.M. As usual, signs will be placed at our two entrances reminding everyone of the meeting.

The Highway 11 entrance sign should be completed by the time the "Islander" is delivered to all residents. The beautiful entrance gives us a new look for the future of our area. Our motto "Waterfront Living At It's Best" should be taken seriously by all residents who are concerned about maintaining property values. Hopefully, decisions will be made on the gutted and ungutted homes in our area and include the FEMA trailers, travel trailers, etc.,etc. Our "Motto" seems to be a stretch of the imagination at the present time, but I am optimistic enough to believe the majority of our residents will do whatever is necessary to make Eden Isles a lovely and desirable area.

More than likely, this will be my final message to all the residents of Eden Isles. I have been blessed with a most cooperative and hard working group of people on our Board of Directors. Additionally, the auxiliary members, committee leaders, and volunteers have been extremely helpful. I have been unsuccessful in my attempt to understand why such a small percentage of people continue to flagrantly disobey the "No Parking" and "No Dumping" signs. I also cannot understand why the majority of our residents do not support their Homeowners Association. This is beyond my comprehension. As I previously mentioned, we only have a specific amount of money, but we have lots and lots of work that must be completed. Everyone in this subdivision should be thankful to the 250 people who have paid the association dues and have supported us in our endeavors to make Eden Isles a better place to live.

Looking forward to seeing you at our March 20th General Membership Meeting.

Did You Know...

The Eden Isles Homeowners Association was incorporated as a non-profit corporation in 1974. The association was formed because of the mutual interest of the Eden Isles property owners. It was thought, at the time, that the spirit of the association should be one of cooperation with all home owners in our community.

The Association is made up of five distinct groups of homeowners.

1. Eden Isles unit three.
2. Eden Isles unit four.
3. Eden Isles unit five.
4. Moonraker Island units one and two.
5. Moonraker Island unit three and four.

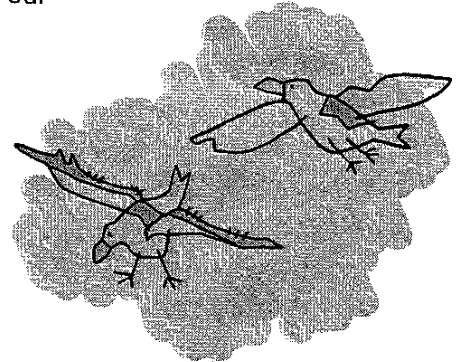

Unit three is made up of one street. Eden Isles Dr. as it is known to some, while others call it Eden Isles Blvd. We all travel Eden Isles Drive to get to our homes. The first home in Eden Isles was on this boulevard and there are approximately 147 houses in this unit.

Unit four is best described as all those who get to their home by way of Windward Passage. There are 25 or more named streets in this unit with over 500 homes. The five most populated streets are 1)Charles Court..79 homes, 2)Blackfin Cove...71 homes, 3)Windward Passage...69 homes, 4)Intrepid Drive...42 homes, and 5)Southern Star...40 homes.

Unit five is made up of two streets; Pebble Beach Dr. and Lakelawn Dr. There are 108 homes on these two streets.

Moonraker Island is made up of two units. Units 1 & 2 go from the first house to about house #217. Units 3 & 4 extend all the way to the end of Moonraker Dr. This is by far the longest street in Eden Isles and has over 260 homes, with about 130 of these in 1 & 2 and the rest in 3 & 4.

BOARD OF DIRECTORS

President - Sal Guarino	985-502-4027
Senior Vice President -Ray Miller	985-641-3321
Programs VP - Wendy Tynes	985-641-1077
Fund Raising - Colin Normand	985-781-2362
Secretary - Liz Hoffman	985-643-9429
Treasurer - Robin Orthober	985-641-1077
Director - Lisa Paul	504-460-0527
Director - Steve Lepakic	985-781-2061
Director - Arbie Herring	985-847-0905



*Colonial
Inspection
Services*



Julie Hufft

P.O. Box 247
Abita Springs, LA 70420
Office: (985) 875-7701
Fax: (985) 875-0747
Email: colonialspec@aol.com

Century 21
Investment Realty

2160 E Gause Blvd, Suite 100
Slidell, Louisiana 70461
Business (985) 643-4200
Cell (504) 462-0044
Fax (985) 643-6167
Toll Free (800) 643-4208
E-Mail wtynes@aol.com
Each Office is Independently Owned And Operated

Wendy Tynes REALTOR®



Office
1998-2005

SMIRNOFF

Crown Royal

Jose Cuervo

SHAQ DISCOUNT

Liquor · Tobacco · Beer · Softdrinks · Ice

4430 Pontchartrain Drive
Slidell, La 70458

Shakeel Nizamuddin
Owner

Ph: (985) 649-9898
Fax: (985) 641-4323

Mandeville/Covington
(985) 898-1440

Slidell
(985) 847-2077

30 Years Experience

AIRCO

AIR CONDITIONING • HEATING INC.

RESIDENTIAL AND COMMERCIAL SALES AND SERVICE

ROY BELLINGER

Cell: 504-669-6844

Service All Makes & Models

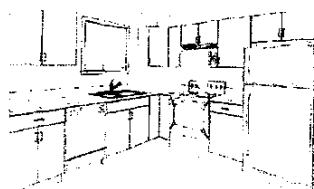

Cabinets Direct

Delivered in less than 2 weeks

504-270-4435

Alan Dugas

Call today for
FREE Consultation!

E-mail us at:
cabinetsin2weeks@aol.com

TITLE EXPRESS, LLC

Notary & Auto Title Co.™

1550 Lindberg * Slidell, LA 70458

(Formerly located next to McDonald's on Pontchartrain Dr)

**NOTARY SERVICES * MOTOR VEHICLE
AND REAL ESTATE TRANSFERS**

Julie C. Flanagan – Notary Public

Office: 985-643-9778 * Fax: 985-643-9178

Meet Alex Cross

Alex Cross is six foot three, weighs 200 pounds, and is athletic. He still lives on Fifth Street in D.C. He still drives his '74 Porsche. Alex Cross is forty-two years old. He has a PH.D. in psychology from Johns Hopkins University, Baltimore, MD. Special concentration in the field of abnormal psychology and forensic psychology. He lives with Nana Mama with his two children Damon and Jannie and a cat named Rosie. Nana Mama is 84 years old.

His wife, Maria, a social worker, was killed in a drive-by shooting that was never solved. Alex Cross has another son, Alex Jr, age three. His mother, Christine Johnson now lives in Seattle with Alex Jr. Cross lost custody because of the dangers involved in his work. They never married.

His hobbies are the piano. Loves to play Gershwin and classical music. Avid reader of fiction and nonfiction. Biweekly boxing lessons with his children.

He joined the Washington, D.C., Police Department as a psychologist, working in Homicide and Major Crimes. Cross is a profiler. He works with VICAP (Violent Criminal Apprehension Program) as a liaison between the FBI and D.C. police. Now an FBI Senior Agent, Cross works in the Hoover Building in D.C.

Alex Cross has solved several murders and if you would like to know how, then go to your local library or book store and read the books by James Patterson. Patterson is the author that brings Alex Cross to life by keeping you guessing until the very end. Patterson's books involving Alex Cross are always with a psychopath's perspective on events, regular surprises, and touches of humor. As always, make sure you've got some time blocked out before you start James Patterson's books. You'll find yourself reading compulsively from the first page.

Alex Cross books order: *Along Came a Spider* - Life changes for Deputy Chief of Detectives Alex Cross when he is drawn into a high-profile case. Two nine-year-old children are kidnapped by a teacher, Gary Soneji, from the prestigious Washington Day School. *Kiss the Girls* - Alex Cross matches wits with Casanova and The Gentlemen Caller. This time it is personal. Naomi Cross, twenty-two-year-old daughter of Cross's deceased brother Aaron, is reported missing. She is a law student at Duke University. *Jack & Jill* - A game of Life and Death. Sam Harrison (Jack) and Sara Rosen (Jill) delight in their board game that has photos of famous people; a simple roll of the dice determines their destiny. *Cat & Mouse* - A killer named Mr. Smith begins his murder spree in Cambridge, Massachusetts, and then starts terrorizing Europe. Bodies are found "gutted." At the same time Gary Soneji taunts Cross with murders in train stations. *Pop Goes the Weasel* - Geoffrey Shafer, the Weasel, works in Intelligence in the British Embassy in D.C. He and three twisted friends play a Game of Death that involves unsuspecting women around the world. *Roses Are Red* - Meet The Mastermind. He's the man behind bank robberies and the murder of bank employees committed in Virginia and Maryland. *Violets are Blue* - A string of gruesome murders points to a vampire subculture in the United States. Cross flies to San Francisco to meet with Inspector Jamilla Hughes, Homicide. *Four Blind Mice* - The Blue Lady Murders occur at Fort Bragg, North Carolina. Army wives are killed and their bodies painted blue. *The Big Bad Wolf* - Zamochit means "the breaking of bones." It is part of a murder ritual practiced by members of the Red Mafiya. *London Bridges* - Geoffrey Shafer, the Weasel, is found and abducted from Salvador, Brazil. The notorious Wolf then sends him on a mission. His first job is to completely wipe out an American town-Sunrise Valley, Nevada. *Mary, Mary* - Hollywood's most famous stars are being murdered one by one. The killer is known only as Mary Smith. Is Mary really a woman? *Cross* - Among the villains Alex Cross has faced one psychopath tops them all. Alex knows him as his wife's killer. Alex may have a chance to catch his wife's murderer after all these years. Is this a chance for justice at long last? Or the culminating scene in his own deadly obsession?

PS: For you ladies that would like to read about heroines instead of a hero they try James Patterson's "The Women's Murder Club"

CONTACT NUMBERS

Louisiana Road Home or www.road2LA.org
1-888-762-3252
3127 Ponchartrain Drive, Slidell LA 70458

Louisiana Insurance Commissioner:
(800)259-5300 or (225) 342-5900

FEMA: www.fema.gov

Red Cross: www.redcross.org

St. Tammany Parish

For help with your property contact: 985-898-3080
or e-mail: propertyhelp@stpgov.org

Hazard Mitigation Program contact: (985)898-3078
or e-mail www.stpgov.org

Parish President, Kevin Davis (985)898-2362

Parish Council (985)898-2591

Engineering (985)898-2552

Environmental Services (985)898-2535

Permits & Regulatory (985)898-2574

Planning (985)898-2529

Public Works (985)898-2557

Social Services (985)898-3074



Petals & Stems

F L O R I S T

Janet & Harrison Bowman

376 Sun Valley Dr. - Slidell, LA 70458 - 985-781-4585

CHASE 

Leigh Ann Rachow
Personal Banker
Investment Representative
Pontchartrain Office

Consumer Banking
LA3-5954
3580 Pontchartrain Dr
SLIDELL, LA 70458

Telephone: 985 661 8885
Facsimile: 985 646 2827
Toll Free: 800 226 2123

Chase Bank USA, N.A.



Redfish Trading Company

Deli • Poboy's • Daily • Specials • Wine • Catering

3605 Pontchartrain Drive
Ph 643-1120 • Fax 643-1150

BUDGET BLINDS

Draperies ~ Blinds ~ Shutters

FREE In-Home Consultation ~ 12 mo. Interest free financing

726-9756

**4015 Pontchartrain Dr.
Jimmy & Kelly Corkern ~ Owners**

Cathy Anne Drolla

Real Estate Consultant

985-649-6333 - Office

985-649-9792 - Fax

985-290-1313 - Cell

Your Realtor @ CathyDrolla.com

www.CathyDrolla.com

2053 East Gause Blvd, Ste 100
Slidell, LA 70461 - USA

Each Office Independently Owned & Operated

DUPRE'S FLOORING INSTALLATION



Tile & Wood

Richard Dupre
Eden Isles Resident

985-285-7534

Hi Again Neighbors!

Here I go again--no signs, no parking, no dumping. This is my second letter since Katrina and not too much has changed. It still costs \$14,000.00 a year for the up-keep of 22 acres of Common Ground. There are people still parking on the boulevard where there are "NO-PARKING" signs. Many still use the Common Ground for their own personal use--parking cars, boats, motor homes and trailers. Some even change the oil from vehicles and leave their trash for someone else to clean up.

Just to remind everyone, it is still against the law to put up signs on trees, stop signs and lamp posts. You can easily be identified because you put your phone number on the sign. We all realize how important your lost dog or cat is, how much you want to sell that boat, or who needs directions to John's birthday party, but doing this could cause you to be fined \$150.00. All signs need to be approved by the Green Force board. Check with the Home Owners Association before you do anything just to be on the safe side.

Please remember to keep your side of the street clean. When you cut your grass, pick up what you can--do not blow it in the street or empty it into canals as this will lead to pollution in our waterways and the lake. Many of us like to swim in these waters so let's keep them clean. Also keep the Common Ground clean and safe for children to play. Let's be proud of where we live and have a safe and clean community.

Remember to pay your dues! This will do a great deal to keep our neighborhood going in the right direction.

I have enjoyed my time serving on the Board of Directors, however it is time for new and young ideas. I will miss the board meetings at the presidents' house. Thank you for all the experience you gave me. I look forward to seeing and living in a brighter and newer Eden Isles.

God bless each and everyone,

Ray Miller

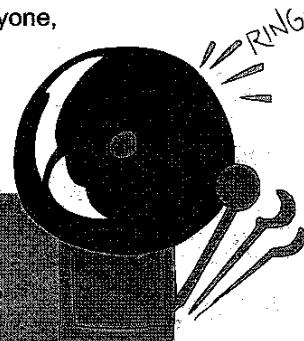

New Burglar Alarm Ordinance

On June 1, 2006 the St. Tammany Parish Council adopted a revision to Article XIII, Chapter 15 of the Parish Code (Burglary and Robbery Alarm Systems - False Alarms). The ordinance is designed to encourage alarm system users and alarm monitoring businesses to assume increased responsibility for maintaining the mechanical liability and the proper use of alarm systems.

The new ordinance will reduce unnecessary police emergency response to false alarms, and thereby to protect the emergency response capability of the Sheriff's Office from misuse.

In short, the ordinance provides for fines for excessive false alarms, provides for discontinuation of the Sheriff's Office response to excessive false alarms, and provides for penalties for violations.

A copy of the ordinance may be downloaded by visiting www.stpsso.org



ROSS EIRICH
EXECUTIVE CHEF

NICK & NATE'S CATERING
3605 PONTCHARTRAIN DR.
SLIDELL, LA 70458

(985) 643-1120 PHONE
(985) 643-1150 FAX

ROSS@NICKANDNATESCATERING.COM

Hurricane Protection & Security



Slidell Shutter Shop

(877) 98-SAFER • TOLL FREE • (877) 927-2337
Local: 985.649.2991 Fax: 985.768.6407
109 Commercial Square Slidell, LA 70461

Hurricane Protection for when the storm has its eye on you.
www.slidellshuttershop.com



Allstate.
You're in good hands.

24-Hour
Customer Service

Juanita N. Plescia
Agent
Plescia Insurance Agency

Allstate Insurance Company
684 Old Spanish Trail
Slidell, LA 70458

Phone 985.726.5001
Fax 985.726.5002
Email A021780@allstate.com

9am to 5pm Monday - Friday
Auto, Home, Business and Life

Distinctive Design

CONSTRUCTION

Marine Pile Driving
Docks • Boat Houses
Piers • Bulkheads
HOBS

www.distinctivedesignconstruction.com

GERALD SAUTER
Owner

Office: (985) 781-5325



2160 E Gause Blvd, Suite 100
Slidell, Louisiana 70461
Business (985) 643-4200
Fax (985) 643-6167
Toll Free (800) 643-4208
Cell (985) 768-8934
E-Mail david.robertson2@century21.com
Each Office is Independently Owned And Operated

Dave Robertson REALTOR®



(985) 643-5424

RENTAL & PRODUCT SUPPORT

Fax: (985) 649-0047

www.tuffequipmentrentals.com

3300 Pontchartrain Dr. * Slidell, LA 70458



WWL 870am • Magic 101.9fm • WKBU 95.7fm
WWL 105.3fm • WSMB 1350am • WEZB 97.1fm

Kathy Esteves

Account Executive
Magic 101.9fm, WKBU 95.7fm, WEZB 97.1fm

Office: (504) 593-1844 • Fax: (504) 593-2203
Cell: (504) 884-8000 • email: kesteves@entercom.com
1450 Poydras Street, Suite 500 • New Orleans, LA 70112



Pontchartrain Ace Hardware

3320 Pontchartrain Dr.
Slidell, LA 70458

Phone: (985) 643-4672
FAX: (985) 641-6051

CRIME STATISTICS

Eden Isles (067)

Incident Type:	Weeks	Year: (to date)	Last Year:
Assault	2	2	9
Burglary- Vehicle	2	2	22
Car Jacking	4	4	10
Death- Investigation	-	-	16
Domestic	1	1	1
Drug Violations	1	1	2
Fire	2	1	2
Rape	-	-	2
Recovered Stolen Vehicles	2	1	2
Robbery	-	-	1
Then- Vehicle	4	4	57
Attempted Theft Vehicle	1	1	9

Oak Harbor (072)

Incident Type:	Last 6 Weeks	This Year: (to date)	Last Year:
Assault	1	1	1
Burglary	-	-	7
Burglary- Vehicle	-	-	21
Criminal Mischief	-	-	7
Domestic	-	-	1
Juvenile	-	-	1
Recovered Stolen Vehicles	-	-	1
Theft	2	2	10
Theft- Vehicle	-	-	2

NOTE: Oak Harbor statistics are provided because the north side of Eden Isles Blvd. and all of Pebble Beach are in Oak Harbor's neighborhood crime boundaries.

For more information on crime and crime prevention in our neighborhood or the rest of St. Tammany Parish, log on to the St. Tammany Parish Sheriffs Office web site at www.stpso.org.

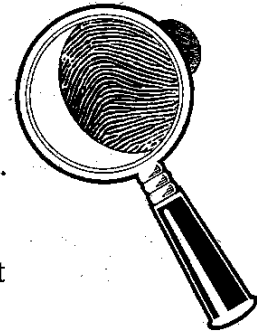

-Report all crimes and violations to the St. Tammany Sheriffs office @ 898-2338 or dial 911-

CRABMEAT CASSEROLE



White sauce

Whisk together until smooth:

- 1/2 stick butter
- 3 level tbsp. flour
- 1 cup half & half cream
- 2oz. sherry
- 1 tsp. Lea & Perrins
- salt and pepper to taste

Add:

- 2 green onions chopped fine
- 1 lb. crabmeat
- 1 8oz. can mushrooms

Place in casserole and sprinkle with cheddar cheese.
Bake 325 degrees 30 min. til bubbly

VEAL CUTLET PARMESAN

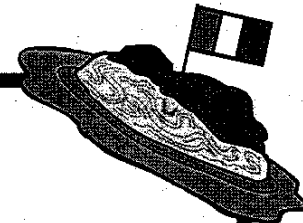

- 1/2 lb. Mozzarella cheese
- 1 cup Italian bread crumbs
- 1/3 cup grated parmesan cheese
- 2 beaten eggs
- 1 can tomato sauce
- 1 lb veal cutlets or venison backstrap
- salt and pepper

Dip seasoned cutlets in beaten eggs then in a mixture of parmesan cheese and breadcrumbs. Fry in olive oil until brown. Place in baking dish, spread with tomato sauce and slices of Mozzarella cheese.
Bake in moderate oven 15-20 min. until hot and bubbly.



PURPLE MARTINS



A Purple Martin house is a Christmas gift that provides many years of enjoyment. It was Christmas of 2004 when I got my first Martin condo. It had four apartments and we had two families move in during February of 2005. We all know what happened next...on August 29, 2005, the Martin house, the fence, deck and just about everything else was destroyed by Katrina.

Christmas of 2005 was somewhat subdued, but our children gave us a larger 12 unit Martin house. We put it up in January and several weeks later in the spring of 2006 we watched eight families of Martins raise 16 babies...what a kick!

Eden Isles is a perfect place to put up a Martin house. They love to be near water. These birds are right at home with their human landlords. The house should be placed on a pole in an open space within 100 feet of your house. A good spot would be in your back yard half way to the water.

These birds arrive sometime in February so they are already in the area as you read this. If you put up a house this year you will probably attract a family or two. Once you have a few, the next year you will attract more. It is thought that about 80% of all Purple Martins live in houses put up by humans.

I would like to recommend a good book about Purple Martins. It is titled "The Complete Guide to Attracting and Housing Purple Martins" written by Donald and Lillian Stokes.

This is a great hobby...have fun with it!



First, a word of appreciation for all those merchants and professionals who purchased an advertisement in this issue. I hope everyone in our neighborhood will avail themselves of their services whenever possible. These fine folks are responsible in a large way for this newsletter.

On our last page you will see a form for the payment of 2007 dues. As Sal mentioned, we only had about 250 dues-paying members in 2006. This is about half the pre-Katrina total. It represents about 20% of our Eden Isles population--WE SHOULD DO BETTER! I know Katrina took a lot out of all of us, however, it is time to resume our lives. If every dues-paying member would entice just one additional non-dues-payer to participate, we would be off and running.

See you on March 20th at the General Membership Meeting.

Eden Isles Homeowner's Association
P.O.Box 2746
Slidell, LA 70459

PRSR STD
U.S. POSTAGE
PAID
CUSTOM MAILER

